

WOODCRAFT CFMOTORSPORTS

105 Baldwinville Rd
Winchendon, MA 01475
(978)297-2977
www.woodcraft-cfm.com

2017 Suzuki GSX-R1000 Rearset Instruction Sheet – Racing Use Only

Thank you for selecting CFMOTORSPORTS rearsets. The components you have just purchased for your motorcycle are designed to improve the ground clearance, crash worthiness and overall good looks of your motorcycle. Please note that these components are intended and approved for **racing use only**. As such, the footpegs are solid-mount and provisions for brake light switches and brake pedal return springs are generally not provided.

- 1) Remove stock rearsets, footpegs and associated hardware. All components that are re-used in this kit should be cleaned and inspected for damage before re-installation.

IMPORTANT

Tighten all fasteners to factory specification or industry standard. FAILURE TO PROPERLY TIGHTEN ALL FASTENERS MAY CAUSE DAMAGE TO THE MOTORCYCLE, LOSS OF CONTROL AND SERIOUS INJURY OR DEATH

Brake Side Assembly Installation

IMPORTANT - All bolts in this assembly **MUST** be secured with **Blue THREADLOCKING COMPOUND**.

- 1) Assemble the brake pedal assembly (09-0252P & 09-4145) with the 04-FH620Z hardware.
- 2) Bolt the brake pedal assembly to the main rearset bracket (05-0252R). Pass the bolt (04-BH835Z) through the pivot pin (05-0225P2) and wave washer (04-WA588WAV). Be sure to generously apply quality waterproof grease to the sliding surface of the pivot pin to ensure smooth lever operation.
- 3) Bolt the footpeg (06-4801) to the main rearset bracket with the 10mm hardware (04-FH1035Z) provided. You may select any of the positions using the locating pin on this eccentric peg.
- 4) Bolt the main bracket to the frame bracket using the OEM hardware.
- 5) Attach the master cylinder to bracket using the stock hardware. You may use either the OEM heel guard or the optional Woodcraft billet guard (05-0249HGB w/04-BH625Z hardware shown in diagram).
- 6) Re-connect the brake pedal to the master cylinder clevis using the OEM pin and clip.
- 7) Attach the pedal tip (08-4899) using the 04-FH620Z bolt. You may adjust the height of the pedal using the eccentric adjustment of the pedal tip and the stock jam nut at the base of the master cylinder clevis.

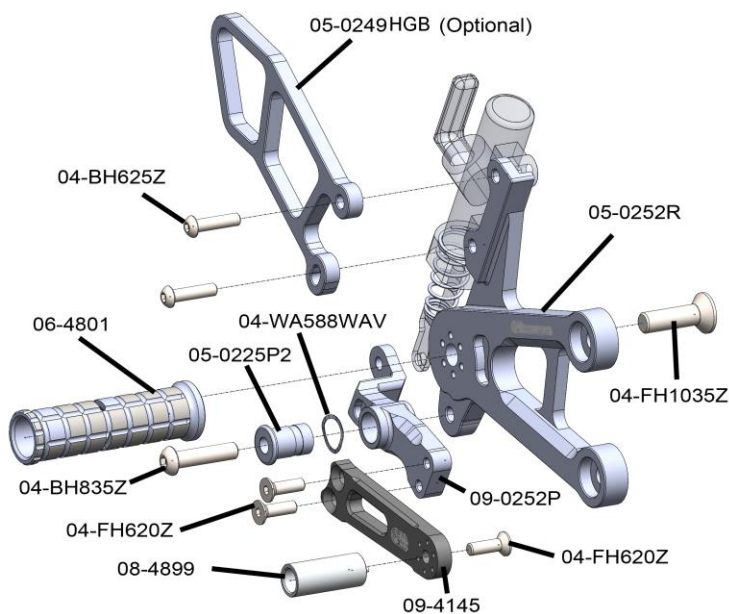

Optional: If you would like a pedal return spring or brake light switch, these items are available from Woodcraft. This kits uses a 09-7252 pedal return spring and a 03-0100 brake light switch.

Shifter Side Assembly Installation

IMPORTANT - All bolts in this assembly ***MUST*** be secured with ***Blue*** ***THREADLOCKING COMPOUND***.

- 1) Bolt the footpeg (06-4801) to the bracket (05-0252L) using the included 10mm hardware (04-FH1035Z). Be careful to use the same eccentric position as you did on the other side of the assembly.
- 2) Bolt the CFM left bracket to the frame using the OEM hardware.
- 3) Assemble the CFM shift pedal (08-0252P, 08-6MLH, 09-4145) with the 04-BH625Z bolt & 04-FH620Z bolts provided.
- 4) Secure the CFM shift pedal to the frame using the OEM shift pedal bolt and hardware.
- 5) Attach the pedal tip (08-4899) using the 04-FH620Z bolt. You may adjust the height of the pedal using the eccentric adjustment of the pedal tip and the OEM shift rod.
- 6) Install the OEM shift rod by simultaneously threading it on the actuator and shift pedal. Rotate the rod turn by turn until the desired pedal height is achieved. Lock the rod in place on both sides using the 6mm nuts on the heim joints. The rod and actuator should be oriented so that they are approximately 90 degrees to each other.

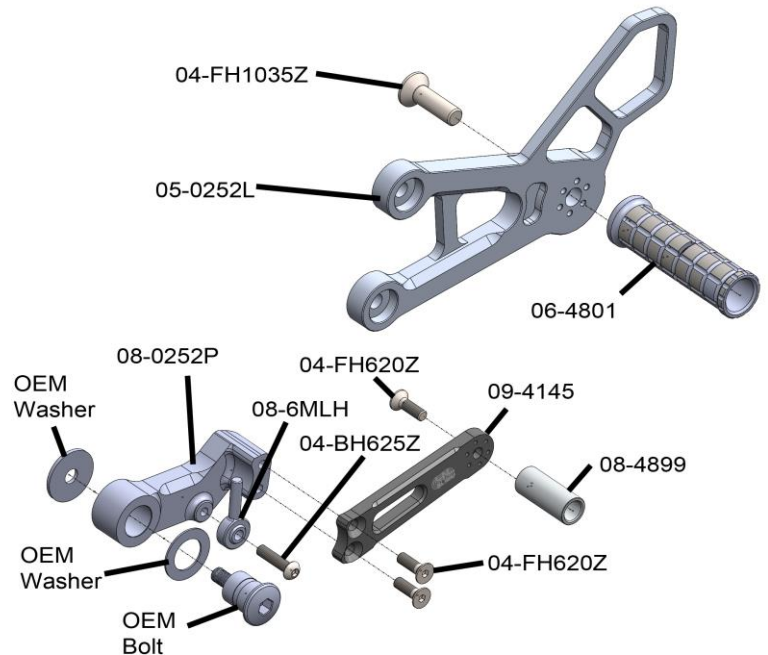

GP shift is accomplished by flipping the gear change actuator (the part attached to the spline on the motor) approximately 180 degrees. The rod and actuator should always be oriented so that they are approximately 90 degrees to each other.

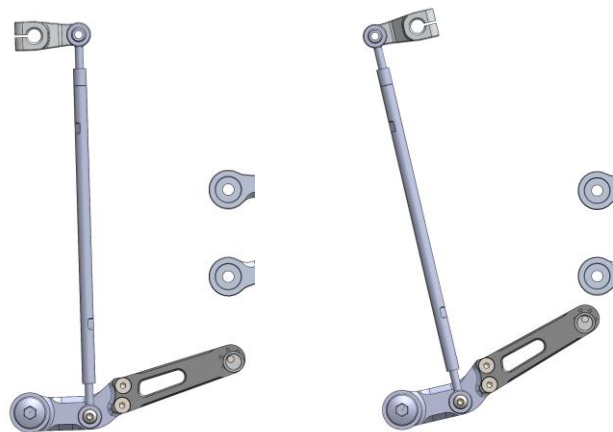

GP Shift

Std Shift

BE SURE THAT ALL COMPONENTS OPERATE AND RETURN FREELY BEFORE USE

If you have any questions regarding installation, please feel free to contact us.

IMPORTANT

Installation and use of this product will change the response of the motorcycle to rider control inputs. Failure of the rider to adapt to these changes may result in a loss of control, and serious injury or death. Improper installation and/or failure to comply with all warnings and instructions may cause a loss of control and serious injury or death. **DO NOT INSTALL OR USE THIS PRODUCT IF YOU ARE UNABLE TO DO SO IN COMPLIANCE WITH ALL INSTRUCTIONS AND WARNINGS. SEEK THE ASSISTANCE OF A TRAINED PROFESSIONAL TECHNICIAN.** Installation of this product releases the Woodcraft Technologies, Inc. from all liabilities as to the use of this product. The user recognizes that any alteration or modification to any motorcycle may increase the risk of injury or accident and may also render the motorcycle illegal for public road use