

IN16-9299 Bar End Slider Instructions

These bar end sliders are intended for use on Woodcraft clipon handlebars.

- 1) Remove the plastic bar end on the Woodcraft bar. This can generally be done with a set of pliers and a little bit of effort.
- 2) Take the base assembly (#3) and put it together by hand. The bolt should engaging a few threads, but still loose.
- 3) Push the assembly into the bar and tighten the 6mm bolt (#4) until the assembly is fully locked in place. (about 10 ft-lbs)
- 4) Slide the base for the hand guard in place and secure it in place with the 6mm clamp bolt. The tolerance is tight, so it may be necessary to open the base slightly with the tip of a flat blade screwdriver. After the base is in place, be sure that the assembly cannot easily spin inside the bar tube.
- 5) Slide the puck (#1) over the base and tighten with the 6mm BH bolt (#2).

ITEM NO.	PART NUMBER	DESCRIPTION	QTY.
1	14-0299	Puck	1
2	04-BH625 S/S	6x25mm BHCS	1
3	14-0250	Base	1
4	04-FH650Z	6x50mm FHCS	1

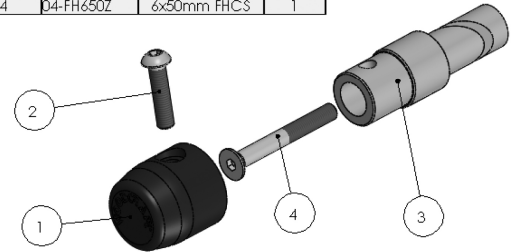

WARNING - VERY IMPORTANT Be sure that the throttle returns freely after being fully opened throughout the entire range of steering. The throttle tube and grip **MUST NOT** contact the bar end slider. **FAILURE TO HEED THESE WARNINGS MAY CAUSE LOSS OF CONTROL OF MOTORCYCLE AND SERIOUS INJURY OR DEATH. DO NOT OPERATE THE MOTORCYCLE IF THERE ARE ANY INTERFERENCE ISSUES WITH EITHER THE MOTORCYCLE PARTS OR YOUR BODY, OR WITH A THROTTLE THAT DOES NOT RETURN FREELY.**

IN16-9299 Bar End Slider Instructions

These bar end sliders are intended for use on Woodcraft clipon handlebars.

- 1) Remove the plastic bar end on the Woodcraft bar. This can generally be done with a set of pliers and a little bit of effort.
- 2) Take the base assembly (#3) and put it together by hand. The bolt should engaging a few threads, but still loose.
- 3) Push the assembly into the bar and tighten the 6mm bolt (#4) until the assembly is fully locked in place. (about 10 ft-lbs)
- 4) Slide the base for the hand guard in place and secure it in place with the 6mm clamp bolt. The tolerance is tight, so it may be necessary to open the base slightly with the tip of a flat blade screwdriver. After the base is in place, be sure that the assembly cannot easily spin inside the bar tube.
- 5) Slide the puck (#1) over the base and tighten with the 6mm BH bolt (#2).

ITEM NO.	PART NUMBER	DESCRIPTION	QTY.
1	14-0299	Puck	1
2	04-BH625 S/S	6x25mm BHCS	1
3	14-0250	Base	1
4	04-FH650Z	6x50mm FHCS	1

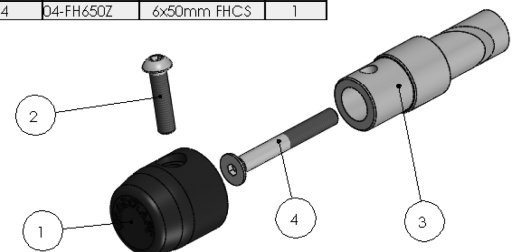

WARNING - VERY IMPORTANT Be sure that the throttle returns freely after being fully opened throughout the entire range of steering. The throttle tube and grip **MUST NOT** contact the bar end slider. **FAILURE TO HEED THESE WARNINGS MAY CAUSE LOSS OF CONTROL OF MOTORCYCLE AND SERIOUS INJURY OR DEATH. DO NOT OPERATE THE MOTORCYCLE IF THERE ARE ANY INTERFERENCE ISSUES WITH EITHER THE MOTORCYCLE PARTS OR YOUR BODY, OR WITH A THROTTLE THAT DOES NOT RETURN FREELY.**